

TURBO-MIST TURBINE REPLACEMENT INSTRUCTIONS

1. CLOSE SADDLE VALVE COMPLETELY.
 2. REMOVE TURBO-MIST FROM PLENUM.
 3. DRAIN WATER FROM RESERVOIR PAN.
 4. REMOVE SCREWS WHICH SECURE TURBINE TO TURBO-MIST.
 5. GENTLY PULL TURBINE AWAY FROM TURBO-MIST.
 6. REPLACE WITH NEW TURBINE. MAKE SURE THAT THE EVAPORATOR SHAFT IS PROPERLY ENGAGED WITH THE TURBINE DRIVE GEAR. *
 7. INSERT SCREWS TO SECURE TURBINE TO THE TURBO-MIST BODY.
 8. RE-INSTALL TURBO-MIST INTO THE PLENUM.
 9. OPEN SADDLE VALVE COMPLETELY.
- * SPIN THE TURBINE BY BLOWING INTO IT TO VERIFY THAT THE EVAPORATOR ROTATES WHEN THE TURBINE ROTATES.

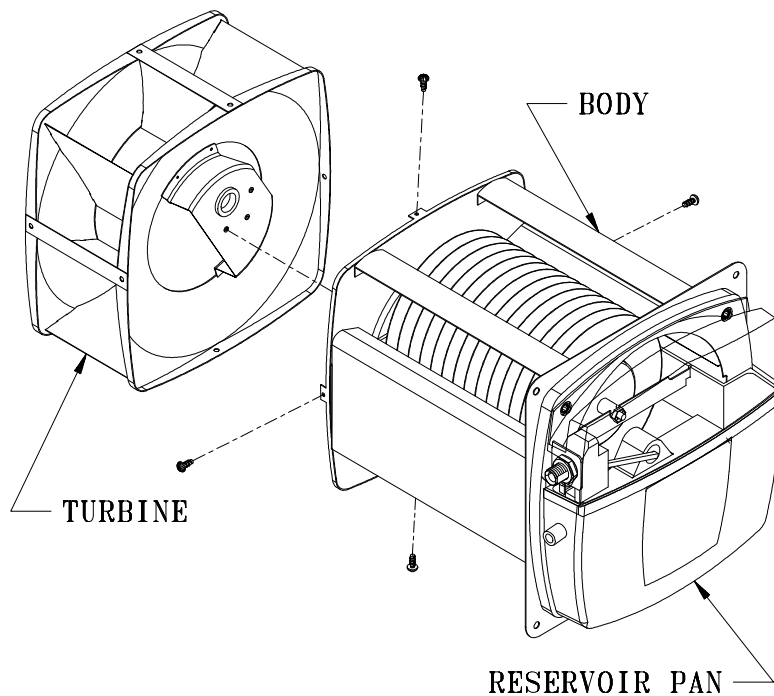

THE FIELD CONTROLS COMPANY

2308 AIRPORT ROAD KINSTON, NC 28501 (919) 522-3031

P/N 4626180