

ENGINEERING DATA



EvenAir RNC Package

Residential New Construction
Whole House Comfort Control System



MODEL PART NUMBER

<input type="checkbox"/> T21 Thermostat SH/1C	580011101
<input type="checkbox"/> T21WF Thermostat WiFi 2H/1C	580011102
<input type="checkbox"/> TS51 Temperature Sensor Single Model	580011301
<input type="checkbox"/> TS52 Temperature Sensor Dual Model*	580011302

*Requires up to 2 Temperature Sensors

AVAILABLE MODULATING DAMPER

<input type="checkbox"/> MD-4 603202304	<input type="checkbox"/> MD-10 603202310
<input type="checkbox"/> MD-5 603202305	<input type="checkbox"/> MD-12 603202312
<input type="checkbox"/> MD-6 603202306	<input type="checkbox"/> MD-14 603202314
<input type="checkbox"/> MD-7 603202307	<input type="checkbox"/> MD-16 603202316
<input type="checkbox"/> MD-8 603202308	<input type="checkbox"/> MD-18 603202318
<input type="checkbox"/> MD-9 603202309	<input type="checkbox"/> MD-20 603202320
<input type="checkbox"/> MD-8X8 603230808	<input type="checkbox"/> MD-16X10 603231610
<input type="checkbox"/> MD-10X8 603231008	<input type="checkbox"/> MD-18X10 603231810
<input type="checkbox"/> MD-12X8 603231208	<input type="checkbox"/> MD-20X10 603232010
<input type="checkbox"/> MD-14X8 603231408	<input type="checkbox"/> MD-22X10 603232210
<input type="checkbox"/> MD-16X8 603231608	<input type="checkbox"/> MD-24X10 603232410
<input type="checkbox"/> MD-18X8 603231808	<input type="checkbox"/> MD-12X12 603231212
<input type="checkbox"/> MD-20X8 603232008	<input type="checkbox"/> MD-14X12 603231412
<input type="checkbox"/> MD-22X8 603232208	<input type="checkbox"/> MD-16X12 603231612
<input type="checkbox"/> MD-24X8 603232408	<input type="checkbox"/> MD-18X12 603231812
<input type="checkbox"/> MD-10X10 603231010	<input type="checkbox"/> MD-20X12 603232012
<input type="checkbox"/> MD-12X10 603231210	<input type="checkbox"/> MD-22X12 603232212
<input type="checkbox"/> MD-14X10 603231410	<input type="checkbox"/> MD-24X12 603232412

DESCRIPTION

The EvenAir® Whole House Comfort Control System works with the heating and cooling appliances to bring temperature balance to the home. EvenAir® system thermostat monitors the sleeping area and living area temperatures. The comfort control automatically adjusts the system airflow. Uniform air delivery balances temperatures for a comfortable home.

The EvenAir® installation is simple. EvenAir® system thermostat is installed where the existing thermostat is located. A temperature sensor is installed in the sleeping area. Area Comfort Dampers that control the airflow to the sleeping area and living area will be installed in the ductwork.

FEATURES

- Every two minutes during a heating or cooling call an adjustment to the airflow will be made if the living and sleeping area temperatures differ by 2°F or more.
- The EvenAir thermostat continues to automatically adjust airflow to find the right distribution for heating or cooling airflow to keep the living and sleeping area comfortable.
- At night the thermostat uses the temperature sensors in the sleeping area to control heating and cooling calls, just as if the thermostat was moved upstairs to the sleeping area.
- Airflow Override feature allows up to 3 hours of directed airflow to living area for special gatherings
- Thermostat provides a large, bright, touch, LCD display
- WiFi version thermostat is directly interchangeable with standard thermostat
- LED lights on damper to indicate open and close positions
- Modulating Damper operation
- Hidden key protected Installer options
- Separate USER/Homeowner options

BENEFITS

- Energy Saving during Night Time Hours
- Standard multi-size dampers available for every installation
- HERS Testing: same as traditional single-thermostat installation
- Requires only one airflow test as compared to zoning testing
- No BYPASS damper required. No energy wasted.
- Lower cost of installation:
 - No zoning panel required.
 - No discharge air sensor.
 - No bypass duct and damper.
 - No barometric damper.
 - Less wires. Uses standard 5 wire between thermostat and air handler.

ELECTRICAL REQUIREMENTS

	Power	Watts
Thermostat	24VAC	1.9VA
MD Dampers	24VAC	2.4VA

APPLICATION



Field Controls
2630 Airport Road
Kinston, NC 28504

Customer Service: 252 522-3031
Fax: 1 (800) 367-7942

Visit us at: www.fieldcontrols.com

Field Controls LLC reserves the right to modify a product, without prior notice, whether in design, color or specifications, in order to offer at all times a quality product that is highly competitive. Please consult your national and local building codes to find out whether the installation of electrical products requires the services of a certified technician or electrician. Field Controls and VentCool™ are registered Trademarks used under license by Field Controls LLC. All rights reserved.

ENGINEERING DATA EVENAIR RNC PACKAGE

WIRING

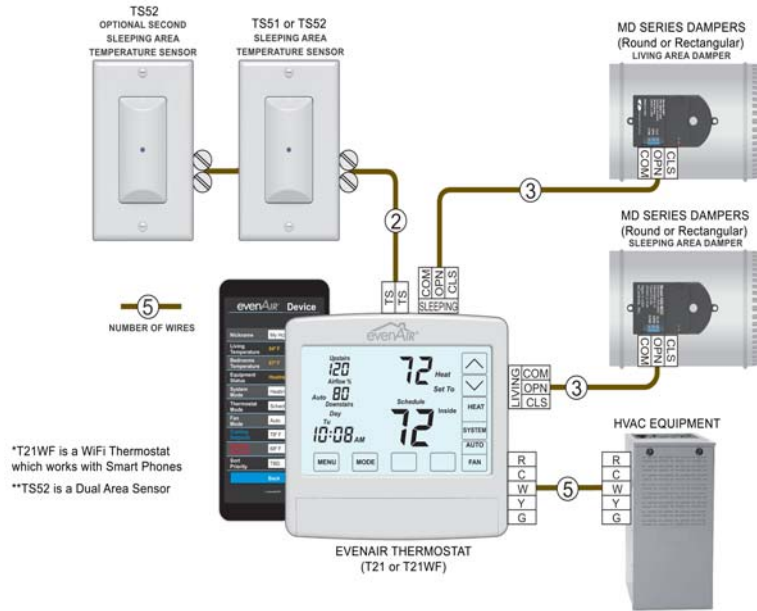

ROUND DAMPER

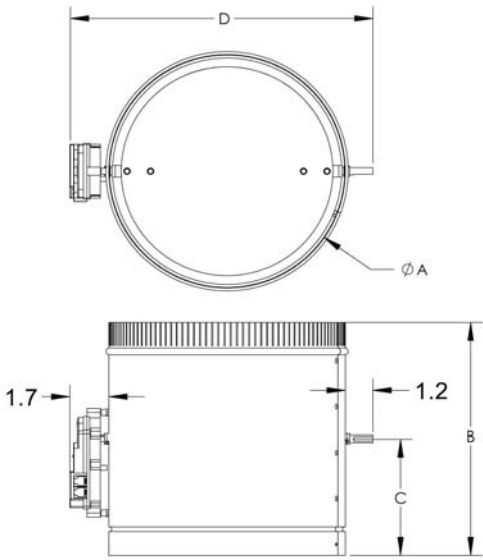

MODEL	A	B	C	D
4"	4.0	10.0	6.0	6.85
5"	5.0	10.0	6.0	7.85
6"	6.0	10.0	6.0	8.85
7"	7.0	10.0	6.0	9.85
8"	8.0	10.0	5.0	10.85
9"	9.0	10.0	5.0	11.85
10"	10.0	10.0	5.0	12.85
12"	12.0	12.0	6.0	14.85
14"	14.0	14.0	7.0	16.85
16"	16.0	16.0	8.0	18.85
18"	18.0	18.0	9.0	20.85
20"	20.0	20.0	10.0	22.85

RECTANGULAR DAMPER

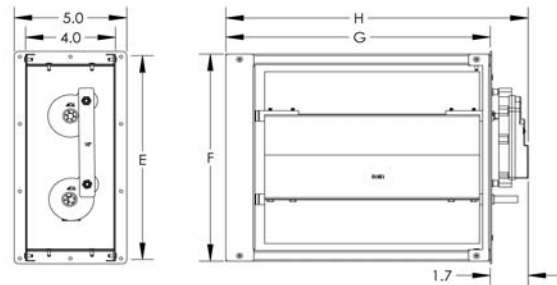

MODEL	E	F	G	H
8X8	8.0	7.75	7.75	9.43
10X8	8.0	7.75	9.75	11.43
12X8	8.0	7.75	11.75	13.43
14X8	8.0	7.75	13.75	15.43
16X8	8.0	7.75	15.75	17.43
18X8	8.0	7.75	17.75	19.43
20X8	8.0	7.75	19.75	21.43
22X8	8.0	7.75	21.75	23.43
24X8	8.0	7.75	23.75	25.43
10X10	10.0	9.75	9.75	11.43
12X10	10.0	9.75	11.75	13.43
14X10	10.0	9.75	13.75	15.43
16X10	10.0	9.75	15.75	17.43
18X10	10.0	9.75	17.75	19.43
20X10	10.0	9.75	19.75	21.43
22X10	10.0	9.75	21.75	23.43
24X10	10.0	9.75	23.75	25.43
12X12	12.0	11.75	11.75	13.43
14X12	12.0	11.75	13.75	15.43
16X12	12.0	11.75	15.75	17.43
18X12	12.0	11.75	17.75	19.43
20X12	12.0	11.75	19.75	21.43
22X12	12.0	11.75	21.75	23.43
24X12	12.0	11.75	23.75	25.43

PROJECT INFORMATION

Quoted by:	Date:
Project:	Remarks:
Quantity:	
Model:	
Site:	
Architect	
Engineer:	
Contractor:	



Field Controls
2630 Airport Road
Kinston, NC 28504

Customer Service: 252 522-3031
Fax: 1 (800) 367-7942

Visit us at: www.fieldcontrols.com