

# ENGINEERING DATA



## VentCool Vista Series

### VentCool™ Whole House Fan (WHF)



#### MODEL PART NUMBER

<input type="checkbox"/>	VentCool 1.7	60510002017
<input type="checkbox"/>	VentCool 2.5	60510002025
<input type="checkbox"/>	VentCool 3.5	60510002035
<input type="checkbox"/>	VentCool 5.0	60510002050

#### ITEMS INCLUDED IN KIT (GENERATION 3)

- Fan assembly with electrical control box
- Duct tape (excluded on 1.7 model)
- 7 feet of acoustically insulated flexduct (excluded 1.7 model)
- 20 ft of 1-3/4 inch wide polypropylene webbing (as required)
- PowerSeal™ Motorized damper assembly
- Fan Collar (as required)
- White cube core inlet grille with fasteners
- Control Package including: Control box, wall controller with mounting bracket and 50 foot cable
- Instruction manual
- Installation hardware

#### OPTIONAL ACCESSORIES

- Remote Control Kit (P/N: 60510003146) includes cables, transmitter and remote module
- Additional Remote Control Module (P/N: 60510003145)

#### ELECTRICAL REQUIREMENTS

VentCool Models	Operating Voltage	Dedicated Circuit (Amps)
1.7	120	2
2.5, 3.5, 5.0	120	15



Field Controls  
2630 Airport Road  
Kinston, NC 28504

Customer Service: 252 522-3031  
Fax: 1 (800) 367-7942

Visit us at: [www.fieldcontrols.com](http://www.fieldcontrols.com)

#### DESCRIPTION

VentCool™ Whole House Fan (WHF) systems from Field Controls are designed to cool the interior of your homes by replacing hot indoor air with cool outdoor air. VentCool fans use about one tenth the electrical power of a traditional home HVAC air conditioning system thus reducing utility costs. System models are offered with PowerSeal™ motorized insulated damper system. The PowerSeal damper products are designed for colder weather regions. All products are supplied with 120 VAC, 10 foot power cord with NEMA (5-15R) connector plug.

#### FEATURES

- Brushed aluminum fan housing
- Wall mounted control center (time and fan speed)
- 7 feet of insulated, noise reducing flexduct (excludes 1.7 model)
- PowerSeal™ Motorized, heavy duty, insulated, self-sealing damper on 1.7, 2.5, 3.5 and 5.0 models
- All models designed to plug into 120 VAC, 15 amp, dedicated power, standard wall outlet
- All models come with a resettable breaker on the main electrical control box

#### BENEFITS

- Dramatic energy savings
- Electronic control modulated (ECM) motors
- Ultra-quiet operation
- Convenient timer settings
- Easy installation
- Heavy Gauge Material
- Aluminum Damper Assembly

#### PRODUCT OFFERING

VentCool Models	Air Flow (CFM) per HVI-916 Std	Power (Watts)	Efficacy (CFM/Watts)	Efficiency (Watts/CFM)	Sound @ 5 FT (dBA)	Fan Motor (HP)	Damper Design	Grille Size (Inch x Inch)	Fan Speed/8 HR timer	R-Value
1.7	1044-1713	105-157	10.9	0.092	44-55	N/A	PowerSeal	14.5x22.5	2	R-47
2.5	723-3253	18-321	10.1	0.099	36-60	1/4 (3)	PowerSeal	14.5x22.5	10	R-49
3.5	723-3440	17-298	11.5	0.087	36-52	1/3	PowerSeal	22.5x26.5	10	R-49
5.0	1367-5350	34-825	6.5	0.154	36-61	3/4	PowerSeal	22.5x26.5	10	R-49

Denotes: (1) Standard design damper assembly (2) Narrow design damper assembly (3) Some units may be configured with 1/3 HP motor

#### DIMENSIONAL DATA - 1.7

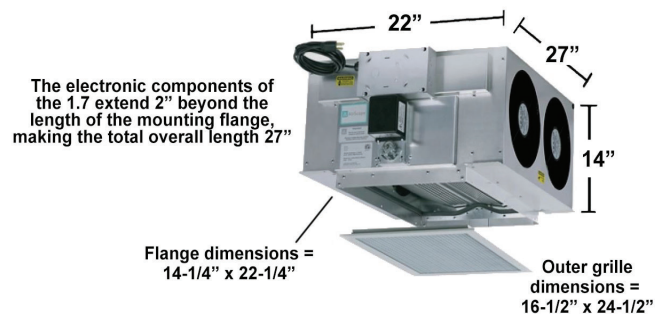

Field Controls LLC reserves the right to modify a product, without prior notice, whether in design, color or specifications, in order to offer at all times a quality product that is highly competitive. Please consult your national and local building codes to find out whether the installation of electrical products requires the services of a certified technician or electrician. Field Controls and VentCool™ are registered Trademarks used under license by Field Controls LLC. All rights reserved.

# ENGINEERING DATA VENTCOOL

DIMENSIONAL DATA - 2.5, 3.5 AND 5.0 (SEE CHART FOR DIMENSIONS)

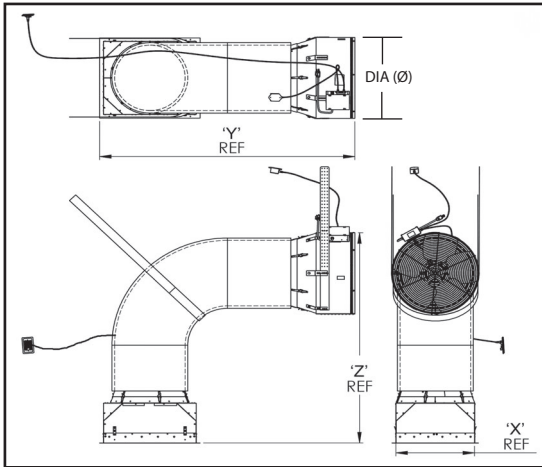

VentCool Models	Dimensions (in inches)			
	X	Y	Z	DIA
2.5	19.3	67.6	63.4	20
3.5 & 5.0	26.9	75.7	70.2	24

(4) Model may be supplied with either 16 or 18 inch diameter fan.

TYPICAL INSTALLATION - VENTCOOL 1.7



TYPICAL INSTALLATION - VENTCOOL 2.5, 3.5, 5.0

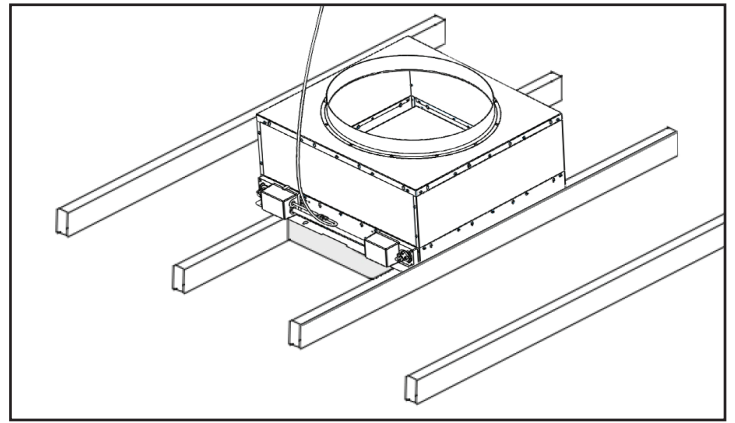

ELECTRICAL CONTROL BOX VENTCOOL 1.7

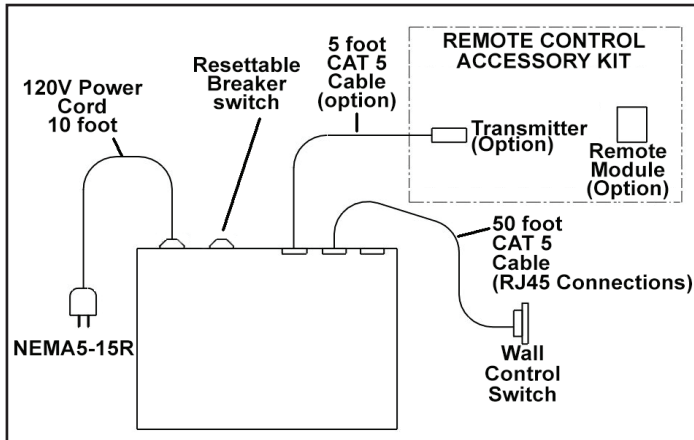

ELECTRICAL CONTROL BOX VENTCOOL 2.5, 3.5 & 5.0

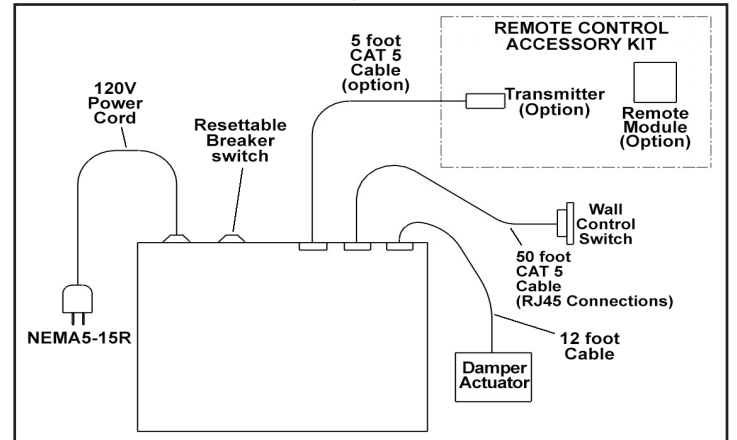

## PROJECT INFORMATION

Quoted by:	Date:
Project:	Remarks:
Quantity:	
Model:	
Site:	
Architect:	
Engineer:	
Contractor:	



Field Controls  
 2630 Airport Road  
 Kinston, NC 28504  
 Customer Service: 252 522-3031  
 Fax: 1 (800) 367-7942  
 Visit us at: [www.fieldcontrols.com](http://www.fieldcontrols.com)